

# Connecting Sequoia LISST-ABS

---

The Sequoia LISST-ABS is a submersible sensor capable of measuring the concentration of suspended sediment in water using acoustic backscatter.

The Sequoia LISST-ABS is compatible with the NexSens X2 data logger using SDI-12 communication protocol. Complete configuration information is located in the manufacturer's manual below.

## Sequoia LISST-ABS Sensor Manual

[https://www.sequiasci.com/wp-content/uploads/2015/04/LISST-ABS-Users-Manual\\_v1\\_3.pdf](https://www.sequiasci.com/wp-content/uploads/2015/04/LISST-ABS-Users-Manual_v1_3.pdf)



# Connecting Sequoia LISST-ABS

## Connectorization

For compatibility, sensors must have UW connectors. There are 3 options:

- Factory installed UW connectors
- UW Plug and Flying Lead cable
- UW Field Wireable Plug

**Recommendation:** Invest in factory connectorization of all sensors for a long-term, robust and waterproof connection

Signal	UW8-Plug Pin	Long Cable option	SDI-12 Pigtail option	UW-FWP	UW-FWP
RS-232 Tx	1	-	-	RS-232 Tx	J <sup>1</sup>
Ground	2	White	Black	Ground	J <sup>2</sup>
RS-232 Rx	3	-	-	RS-232 Rx	J <sup>3</sup>
5V	4	-	-	5V	J <sup>4</sup>
12V	5	Red	Red	12V	J <sup>5</sup>
SDI-12	6	Black	Green	SDI-12	J <sup>6</sup>
RS-485 B	7	-	-	RS-485 B	J <sup>7</sup>
RS-485 A	8	-	-	RS-485 A	J <sup>8</sup>



UW to Flying Lead Cable

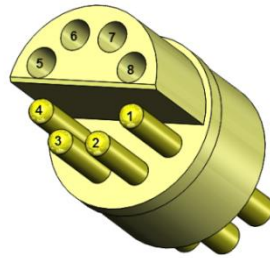

UW-8P



UW Field Wireable Plug

